

INDEPENDENT LIVING

APPRVD
BY
ENG

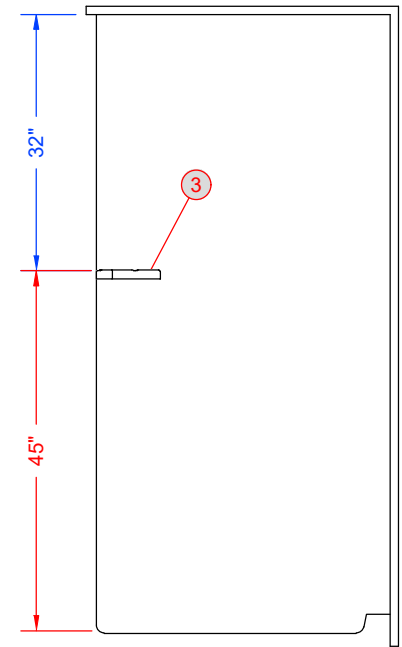
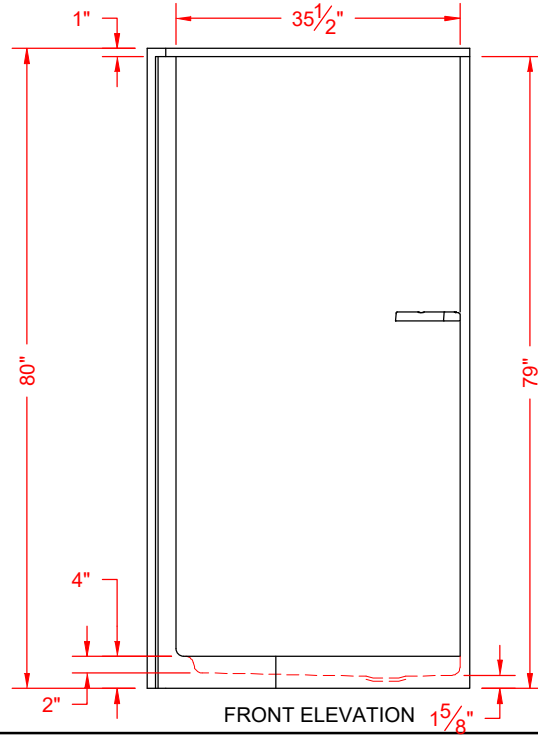
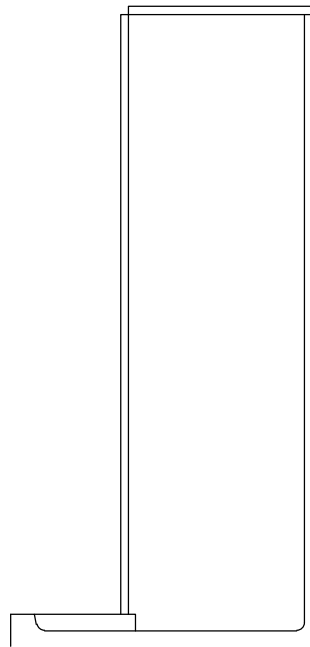
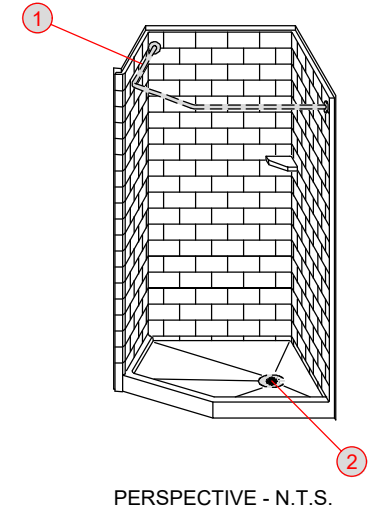
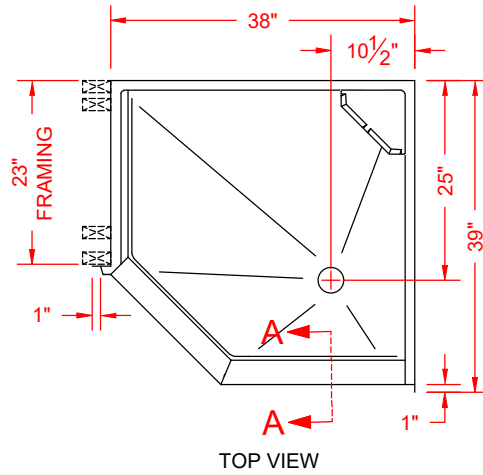

E	---	---
D	---	---
C	---	---
B	---	---
A	Rod was for neo 4242	TAG 03/06/20
REV	CHANGE	DATE

PROJECT: ADVENT FISH
COMPANY: Advent health



NOTES:
 • Rough-in stud opening +1/4" -0" nominal dimensions
 • All vertical accessory dimensions are measured from the floor of the shower.
 • Best Bath Systems, Inc. retains ownership of all product designs and any proprietary information may not be disclosed to its competitors, their agents or affiliates.

DB:BLG	SCALE: 1/2" = 1'-0"	DATE: 01/09/20
CB:JMB	SHEET 1 OF 2	DRAWING NUMBER: 19176

ACCEPTED AS CORRECT BY:
 Selected threshold height and type are compatible with flooring materials

X _____ / /

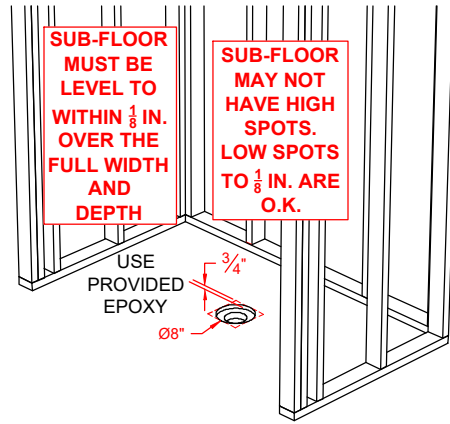

FRAMING POCKET REQUIREMENTS

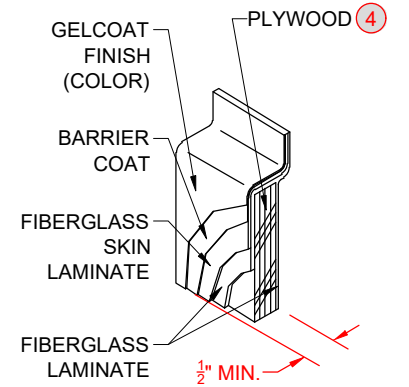

LAMINATE DETAIL C - SCALE: 3" = 1'-0"

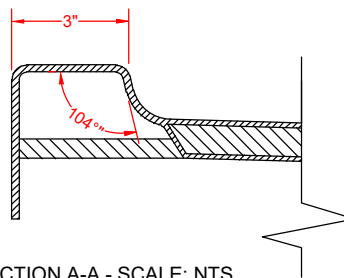

SECTION A-A - SCALE: NTS

VALVE PACKAGE DETAILS:

A	-	N/A						
PLUMBING TREE:		N/A						
PT NIPPLE SIZE:		N/A	SUPPLY TEST:		N/A			
PLUMBING TREE CUSTOM PARTS:		N/A						

FOR THE PROTECTION OF YOUR ACCESSORIES, SOME ITEMS INCLUDED IN THE VALVE PACKAGE WILL NOT BE INSTALLED AT THE FACTORY. THESE ITEMS INCLUDE, BUT ARE NOT LIMITED TO, THE SUPPLY ELBOW, VACUUM BREAKER, HOSE, AND HAND SHOWER.

15								
14								
13								
12								
11								
10								
9								
8								
7								
6								
5								
4	-	FULL PLYWOOD BACKING				✓		
3	1	CORNER MOUNT SOAP DISH	WHITE	SDCORNER90		✓		
2	1	KIT - INCLUDES STANDARD NO-CAULK BRASS DRAIN FOR PVC/ABS AND LOOSE OATEY 42158 GASKET FOR CONNECTION TO 2" COPPER DWV PIPE		KACXDRAIN2001			✓	✓
1	1	CORNER CURTAIN ROD KIT FOR LBNS3838CP		CRKLBNS3838CP			✓	
KEY	QTY.	DESCRIPTION	COLOR	PART NUMBER	FACTORY INSTALLED	INSTALLED BY OTHERS	MARK LOCATION ONLY	PRE-DRILL HOLES

PARTS LIST

NOTES:
N/A

DATE: 01/09/20

DRAWING NUMBER:
19176

REFER TO SHEET 1 OF 2 FOR ACCESSORY LOCATIONS

SHEET 2 OF 2

